



## PT 20I

### **Noblelift Power Electric Pallet Truck with Mast Lift for Order Picking**

#### **INTRODUCTION**

The PT 20I is the ideal choice if transportation operations need to be combined with health-friendly order picking operations.

The low-lift transportation capacity of max. 2000kg is enough to unload delivery lorries and to do picking operations in the warehouse or in the salesroom.

The sideways lifting buttons are ergonomically located nearby the picking area.

#### **ADVANTAGES**

- Power pallet truck with additional health-friendly mast lift.
- AC drive system
- Long tiller for easy and ergonomic operations.
- Slow-speed button for safe operations in narrow spaces.

# PARAMETERS

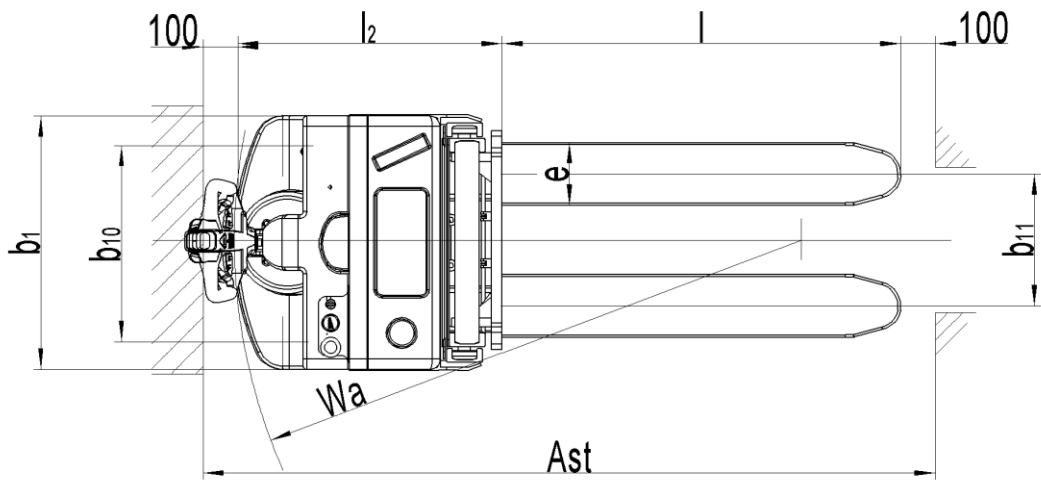
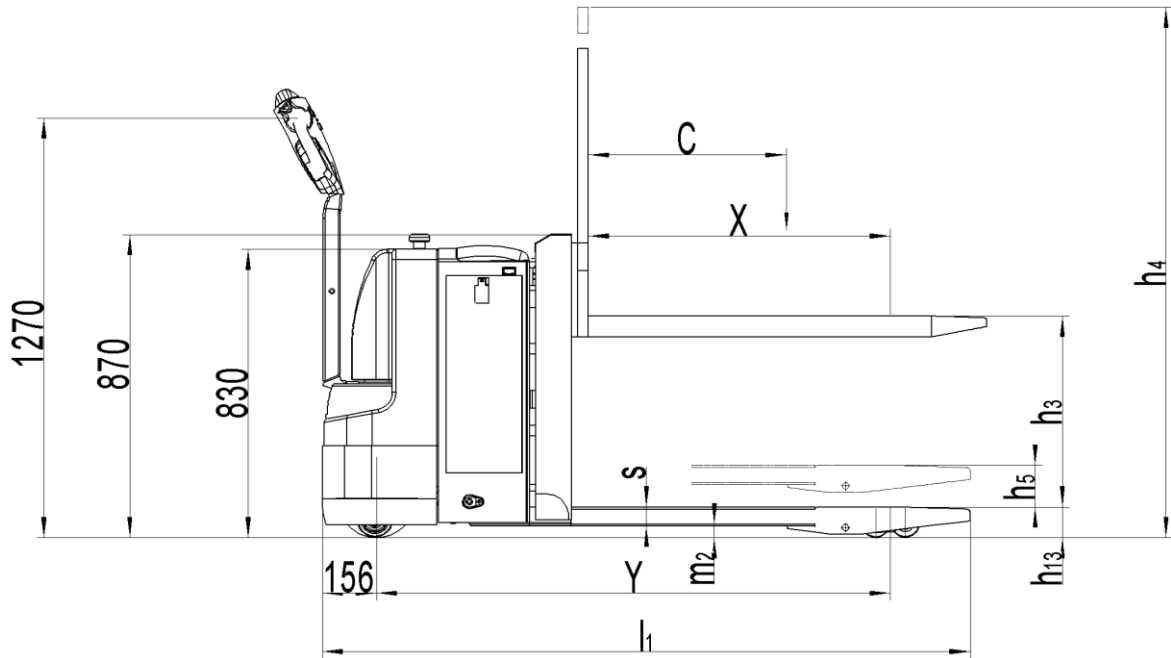

# Type sheet for industrial truck acc. to VDI 2198

1KG=2.2LB 1INCH=25.4MM

<b>Distinguishing mark</b>	1.2	Manufacturer's type designation		<b>PT 201</b>
	1.3	Drive		Battery
	1.4	Operator type		Pedestrian
		Load capacity / rated load	Q (t)	2
	1.5	Load capacity at mast lift	Q (t)	1 1)
		Load capacity at support arm lift	Q (t)	2 1)
	1.6	Load center distance	C (mm)	600
	1.8	Load distance ,centre of drive axle to fork	X(mm)	872
	1.9	Wheelbase	Y (mm)	1481
<b>Weight</b>	2.1	Service weight	kg	690
	2.2	Axle loading, laden front/rear	kg	703/1985
	2.3	Axle loading, unladen front/rear	kg	420/268
<b>Tyres, chassis</b>	3.1	Tires		Polyurethane (PU)
	3.2	Tire size, front	Ø x w (mm)	Ø 230 x75
	3.3	Tire size, rear	Ø x w (mm)	Ø 80x70
	3.4	Additional wheels(dimensions)	Ø x w (mm)	Ø 100x40
	3.5	Wheels,number front/rear(x=driven wheels)		1x+2/4
	3.6	Tread, front	b10 (mm)	500
	3.7	Tread, rear	b11 (mm)	380
<b>Wheels, Chassis</b>	4.4	Lift	h3 (mm)	550
	4.5	Extended maximal height	h4 (mm)	1530
	4.6	Initial lift	h5(mm)	120
	4.9	Height of tiller in drive position min./ max.	h14 (mm)	1270
	4.15	Height, lowered	h13 (mm)	90
	4.19	Overall length	l1 (mm)	1915
	4.20	Length to face of forks	l2 (mm)	765
	4.21	Overall width	b1 (mm)	730
	4.22	Fork dimensions	s/e/l (mm)	60 / 180 / 1150
	4.25	Distance between fork- arms	b5 (mm)	560/510
	4.32	Ground clearance, centre of wheelbase	m2 (mm)	25
	4.33	Aisle width for pallets 1000x1200 crossways	Ast (mm)	2450
	4.34	Aisle width for pallets 800x1200 lengthwise	Ast (mm)	2355
	4.35	Turning radius	Wa(mm)	1640
	<b>Performance data</b>	5.1	Travel speed, laden/ unladen	km/h
5.2		Lift speed, laden/ unladen	mm/s	90/130
5.3		Lowering speed, laden/ unladen	mm/s	80/65
5.8		Max. gradeability, laden/ unladen	%	6/10
5.10		Service brake		Electromagnetic
<b>Electric- Motor</b>	6.1	Drive motor rating S2 60min	kW	1.5
	6.2	Lift motor rating at S3 10%	kW	1.2
	6.3	Battery acc. to DIN 43531/ 35/ 36 A, B, C, no		no, 3VBS
	6.4	Battery voltage, nominal capacity K5	V/ Ah	24/ 210
	6.5	Battery weight	kg	185
	6.6	Energy consumption acc. to VDI cycle	kWh/h	1.0
<b>Additional data</b>	8.1	Type of drive control		AC- speed control
	8.4	Sound level at driver's ear acc. to EN 12053	dB(A)	<70

# KEY FEATURES



- 1 Noblelift AC drive system  
The AC drive system for high performance and low maintenance



- 4 The sideways located lifting-/lowering buttons makes the picking process more faster and effortless



- 6 Additional health- friendly mast lift height up to 760mm with 1000kg capacity.



- 2 The long and ergonomic CAN-Bus tiller ensures easy and ergonomic operations by providing a long and safe distance between operator and truck.

- 3 The slow-speed button assists the operator for operations in narrow spaces.



- 5 Powerful 210Ah traction battery for longer operations

- 7 The backrest assists to place the goods well placed on the pallets and makes the picking process safer.

## NOBLIFT

### NOBLELIFT CHINA

Add: No. 528, Jing Yi Road Economic Development Zone,  
Changxing zhejiang China PC: 313100  
Tel: 86-572-6210776 6210788 Fax: 86-572-6210777 6128612  
www.noblelift.com Email: info@noblelift.com

### NOBLELIFT EUROPE GMBH Spare Parts Center

Add: Borsigstrae 9D-93092 Barbing Germany  
Tel: +49 9401 607930 Fax: +49 9401 6079329  
www.noblelifteurope.com Email: inter@noblelifteurope.com

### AMERICAN NOBLELIFT CORP.

Add: 1810 S. Milliken Ave., Ontario, CA 91761, USA  
Tel: +1 909 390 6258 Fax: +1 909 390 5114  
Toll Free #: (888) 662-5354  
www.nobleliftus.com Email: info@nobleliftus.com

### SPARE PARTS CENTER

Borsigstrae 9D-93092 Barbing Germany  
Tel: +49 (0) 9401 911 330 Fax: +49 (0) 9401 911 3329  
Email: parts@noblelifteurope.com